

Courses and distances
down the river and up
the Creek

N 22 W 148

S 63 W 83

S 80 W 60

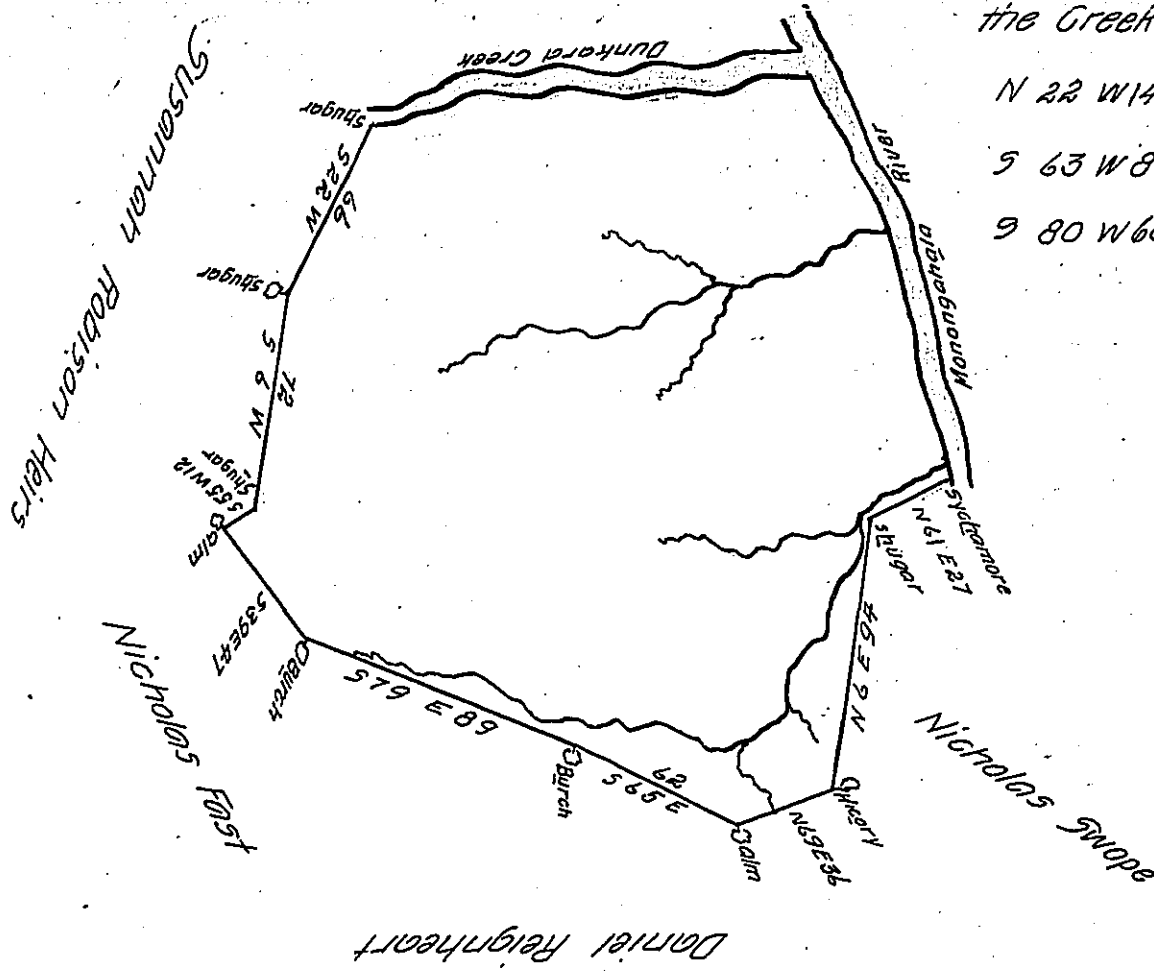

The above is a draught of a survey made December 20th 1785
in pursuance of a warrent granted Phillip Lewis dated Octo 8th 1785
Called Painter Hill containing 270 and 112 perches with 6th cent allow-
-ance and is situate in Washington County

To John Lukens Esq. J. G.

David Redick D. S.

IN TESTIMONY that the above is a copy of the original remaining on file in
the Department of Internal Affairs of Pennsylvania, made
conformably to an Act of Assembly approved the 16th day of
February, 1833, I have hereunto set my Hand and caused
the Seal of said Department to be affixed at Harrisburg,
this twenty seventh day of September 1905

Isaac R. Brown
Secretary of Internal Affairs.